

2010 COACH HOUSE PLATINUM 232XL

■ COLOR: Studio (optional deluxe full-body paint)



Live Large in a Smaller Motorhome

THE COACH HOUSE® Platinum® 232XL answers the question, "How much luxury can you build into an easy-to-drive 23-foot motorhome?" Well, check it out:

- ✓ Permanent double bed? *Check.*
- ✓ Full bathroom with an enclosed stand-up shower and separate porcelain commode? *Check.*
- ✓ Well-equipped kitchen, with solid-surface countertops, recessed sink and stove with covers, refrigerator, range hood with monitor panel, microwave/convection oven and ample storage? *Check.*
- ✓ Plenty of room for dining and relaxing? *Check.*
- ✓ Entertainment center? *Check.*

How did we manage to get so much living space into a 23-foot RV? With two trouble-free HWH hydraulic slideouts. At the push of a button, the front sofa or dinette slides out, opening up valuable space in the heart of the unit, where you will be cooking, relaxing or entertaining. Push another button, and the double bed in the rear slides out, providing easy access to the bathroom and storage.

The Platinum 232XL is available in two well-thought-out floor plans, a Front Dinette (which can be converted to a twin bed) and a Front Sofa (with a motorized sofa that folds down into a double bed).



■ FLOOR PLAN: 232XL FD ■ DECOR: Studio



■ FLOOR PLAN: 232XL FD ■ DECOR: Studio

ABOVE: View to the rear shows permanent double bed (left) and bathroom. Kitchen and dinette are in the front of the coach.

LEFT: Permanent double bed is contained in its own slideout. A 23-foot motorhome has never felt so spacious!

232XL FD Front Dinette with two slideouts

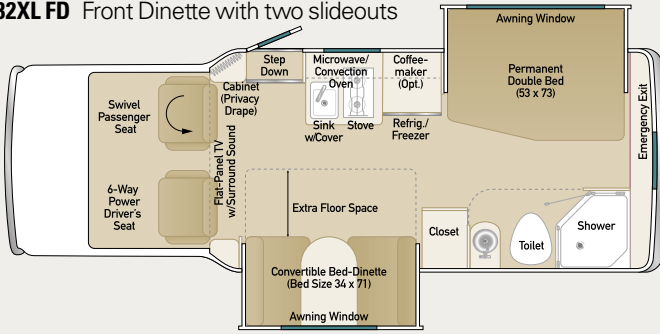

232XL FS Front Sofa with two slideouts

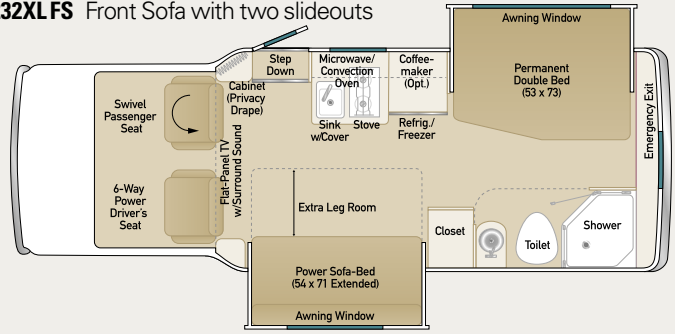

S = Standard O = Optional

INTERIOR FEATURES

- Three color choices:
 Wellington (traditional);
 Lido (transitional);
 Studio (contemporary) S
- Expansive overhead cabinetry S
 Large wardrobe closet S
 Solid-surface counter tops S
 26" flat-panel HD TV w/swing arm S
 DVD player S
 Day-night shades S
 TV antenna S
 Front privacy drape on overhead track . . S
 Premium-grade carpet and floor coverings S
 6-way power driver's seat S
 Swivel front passenger seat S
 Mirror in bathroom S
 Separate 6-ft 2-in. stand-up shower . . . S
 Porcelain toilet S
 Lavatory sink S
 Fire extinguisher S
 Dashboard kit S
 Optima leather-touch upholstery S
 Bose 3-2-1 Surround Sound for front TV 0
 15-in. flat-panel HD TV in bedroom w/DVD 0
 Rear view mirror w/compass and outside temperature 0
- ## EXTERIOR FEATURES
- Patented aerodynamic one-piece body . . S
 Electric entrance step with light S
 Class III trailer hitch S
 Exterior storage compartments S
 Recessed spare tire S
 1.5-inch square-tube steel floor frame . . S
 Stainless steel wheel simulators S
 Exterior hot and cold shower S
 Full-size side entry door w/screen S
 Telephone and cable TV jacks S
 Two HWH hydraulic slideouts S
 Firestone Ride-Rite air suspension system w/compressor S
 Primary windows (dual-pane) S
 White exterior paint (vinyl graphics) . . . S

CHASSIS FEATURES

Ford E-450 Super Duty Chassis (158-in. wheelbase) with 6.8-liter Triton V-10 engine; automatic 5-speed TorqShift transmission with tow/haul mode; power steering; power windows; power door locks; keyless remote entry; power side mirrors; 55-gallon fuel tank; 4-wheel anti lock disc brakes; spare tire and rim; air conditioning; cruise control; AM/FM/CD stereo; tilt steering wheel; intermittent wipers; front chrome bumper and grill; aero halogen headlamps; light and convenience group; driver and passenger airbags.

- Basic full-body paint 0
 Deluxe full-body paint 0
 HWH automatic hydraulic leveling system 0
 13-foot retractable box awning 0

GALLEY

- Two-burner LP gas stove S
 Range hood with monitor panel S
 Convection/microwave oven S
 Recessed kitchen sink w/cover S
 6-cu.-ft. three-way refrigerator S
 Built-in coffeemaker S

SELF-SUPPORTING SYSTEMS

- All-weather interior plumbing S
 Concealed 68-lb. propane tank S
 6-gallon electric/engine assist water heater w/ bypass valve S
 Porcelain flush toilet S
 Demand fresh water system S
 City water connection S
 Universal utility compartment S

HEATING AND COOLING

- 13,500-Btu ducted roof air conditioner with heat strip S
 30,000-Btu auto LP gas furnace S
 Two Fantastic roof vents with thermostat, rain sensor and 3-speed fan S
 Heavy-duty insulation R-18 S
 Heated holding tanks 0

ELECTRICAL

- 110v/12v 45-amp converter/charger . . . S
 Ample 110v electrical outlets S

- Security alarm 0
 Additional 3rd auxiliary battery 0
 Solar battery charger 0

DIMENSIONS

- Wheelbase 158"
 Overall length 23' 2"
 Overall width 8' 0"
 Overall width with slideouts extended 11'
 Overall height incl. A/C 10' 5"
 Interior headroom 6' 3"
 GVWR (max. weight of loaded vehicle) 14,500 lbs.
 GCWR (max. weight of loaded vehicle plus tow) 20,000 lbs.
 Rear axle ratio 4.56 to 1

BED SIZES

- Power sofa (FS only) 54" x 71"
 Dinette bed (FD only) 34" x 71"
 Double bed w/innerspring mattress 53" x 73"

TANK CAPACITIES

- Fuel tank 55 gal.
 Fresh water tank 28 gal.
 Grey water tank 28 gal.
 Black water tank 25 gal.



3480 TECHNOLOGY DRIVE · NOKOMIS, FL 34275
 (941) 485-0984 · Toll-free 1-800-235-0984
 www.coachhouserv.com · E-mail: info@coachhouserv.com

Your Authorized Coach House® Dealer